



Installation Guide

BOSK PANEL

Bosk Panels must be installed by qualified tradesmen. Panels may be cut to size on-site. A suitable skill saw with a fine tooth crosscut blade (Carbide tipped) and straight edge can be used.

Bosk Panels are an interior panel and are fixed to framing as you would any other Plywood or MDF panel. See table below for recommended fixing details. A good quality construction glue can be used with either a 50mm panel pin or counter sunk screw. For the stepped slot (secret fixing) a counter sunk screw can be replaced with a 6 gauge pan head screw.

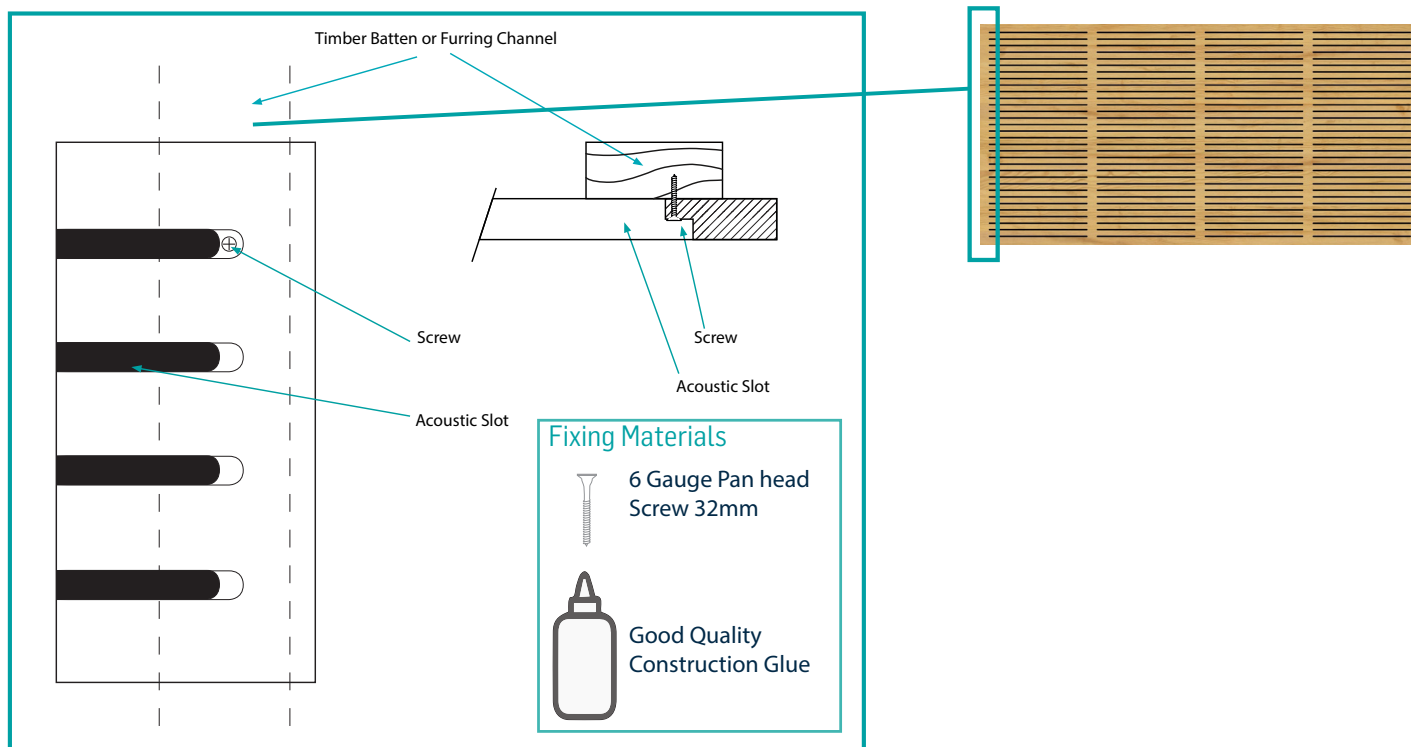

MATERIAL THICKNESS (mm)	MAXIMUM FRAMING CENTRES (mm)	FASTENER CENTRES PERIMETER (mm)	FASTENER CENTRES INTERMEDIATE(mm)	EXPANSION JOINTS REQUIRED
MDF		Walls and Ceilings		
9.0	450	200	300	No
12.0 - 18.0	600	200	300	
Ply		Walls		
6.0	450	150	200	
		Ceilings		
6.0	600	150	200	
		Walls and Ceilings		
9.0 - 12.0	600	200	300	No
16.0 - 25.0	600	300	400	



Installation Guide

BOSK PANEL

Bosk Panels are a prefinished timber product and as such, should be treated with reasonable care.

The joints can be Butt Jointed, expressed with a Vee Joint or with a negative detail.

BUTT/VEE JOINT

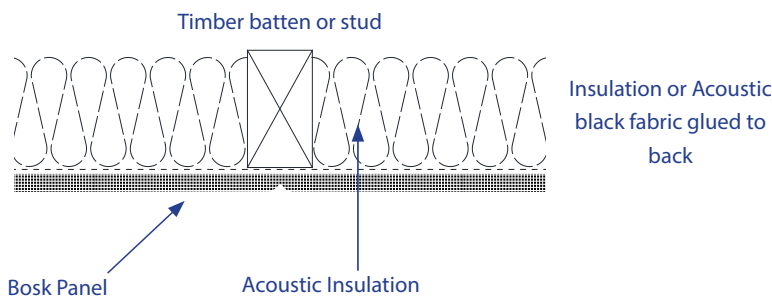

NEGATIVE DETAIL

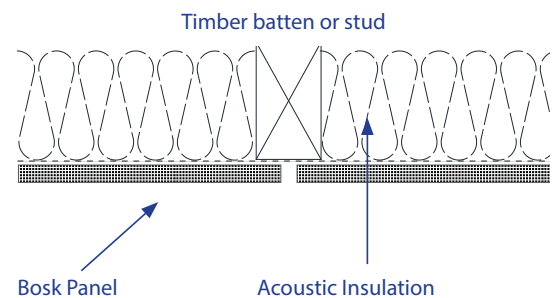

The use of acoustic fabric and polyester insulation simultaneously can have a negative effect on the NRC. Do not use together if there is any chance of the polyester resting on the fabric (using with an airgap is fine). If extra absorption is required when an airgap cannot be maintained; use polyester insulation without fabric.

HANDLING

Keep work area clean and where possible, use 2 persons to lift each sheet. Avoid sliding on the decorative surface.

STORAGE

Bosk Panels come pre-packaged in a solid sided pallet. This is to help with protection during travel. When storing, make sure that panels are protected from direct sunlight and moisture. Remove solid top and sides to allow panels to equalise within the environment that they will be installed into. If panels are removed from pallet and stored loose, please ensure that there is sufficient support to protect panels from sagging/warping prior to installation.

Inspect panels for any defects prior to installation. Installation is deemed as acceptance of goods.